

Mode Field Adaptor

Features

Low insertion loss
High Efficiency
stability and reliability

Application

Wave Fiber Laser
High-Power Laser Equipment
Experimental tests and other areas

Description	Parameter	Unit	Note
Type	MFA		
Signal Wavelength	1064	nm	
Signal Input Fiber	6/125-0.14NA	μm	
Signal Output Fiber	Liekki-Passive-10/125-SC-0.08NA	μm	
Signal Insertion Loss	0.5	dB	
M ²	1.1		
Power Handling	10	W	
ER	-	dB	
Operating Temperature	-5-+70	℃	
Storage Temperature	-20-+70	℃	
Fiber Length	1.1	m	
Dimensions	50*5*5	mm	glass tube

Mechanical Dimension

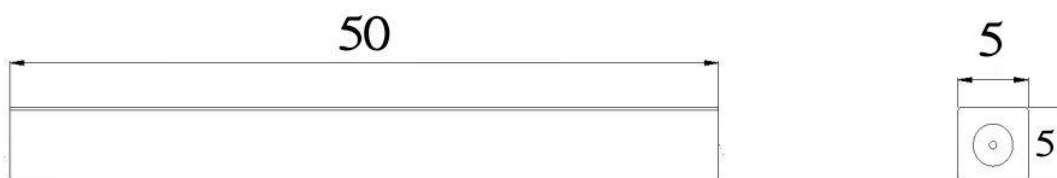

Ordering Information

GCMFA-1x1-F-1064-10W-50x5x5-1.1m