

780~880nm High Power In-line Isolator**Features**

Low insertion loss
High extinction ratio
High stability & Reliability

Applications

Fiber Amplifier
Fiber sensor
Fiber Laser Marking
Laboratory R&D

Parameter	High power in-line isolator, HPIIT	Unit
	Non-PM isolator	
Operating wavelength	780 、 808、 850、 880 or customized	nm
Bandwidth	±5	nm
Peak isolation	≥25	dB
Isolation in band at 23°C	≥22	dB
Insertion loss at 23°C	≤1.5	dB
Polarization dependent loss	≤0.2	dB
Extinction ratio	/	dB
Return loss	≥45	dB
Fiber type (can be customized)	HI 780C or SM800	-
Input max. power handling	10	W
Dimensions (L x W x H)	108 x 27 x 27	mm
Operating temperature	-5 ~ +50	°C
Storage temperature	-20 ~ +70	°C

*Type B: Both axis working, Type F: Fast axis blocked.

*Back Reflect Power< 10% Max Forward Power.

*The Above specifications is without connector, IL is 0.80dB higher, RL is 5dB lower and ER is 3dB lower for each connector added. The default connector key is aligned to slow, the connector handle power ≤0.3W.

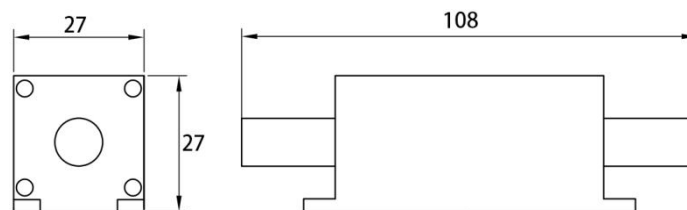
Mechanical Dimension**Ordering Information**

specification	GCHPIIT
Fiber length	specify
Package size	108 x 27 x 27
Connector type	FC/APC, FC/APC etc
power condition	C=Continue Wave, P(10)=Pulse Peak Power(10KW),etc
Fiber type	Hi780C,SM800, SM85-PS-U25D, etc
Pigtail diameter	0=bare fiber, 1=900μm
Operating wavelength	980nm etc