

High Power Expanded Beam Collimator

Features:

Low insertion loss
High Efficiency
stability and reliability

Application:

Wave Fiber Laser
High-Power Laser Equipment
Experimental tests and other areas

| Parameter | | Value | Unit | Note |
|----------------------------|------------|-----------------------------|------|------|
| Operating Wavelength | | 1550&1064&1030 or Specified | nm | |
| Insertion Loss | | ≤ 0.3 | dB | |
| Return Loss | | ≥ 50 | dB | |
| Beam Diameter ($1/e^2$) | | 0.3 ± 0.1 | mm | |
| Ellipticity | | - | % | |
| M ² Degradation | | - | % | |
| Divergence (Full Angle) | | - | mrad | |
| Fiber Type | | PM980 or PM1550 or specify | - | |
| Φ3mm Armored Cable Length | | 0.55 | m | |
| Φ0.9mm Loose Tube Length | | 0.65 | m | |
| Fiber Length | | 1.0 | m | |
| Max. Power Handling | Average | 0.5 | W | |
| | Pulse Peak | 200 | W | |
| Operating Temperature | | +5 ~ +55 | ℃ | |
| Storage Temperature | | -5 ~ +75 | ℃ | |
| Dimensions (Φ*L) | | Φ4x25 | mm | |

*Insertion loss of light through fiber cladding is not included in the Insertion loss specification.

Mechanical Dimension

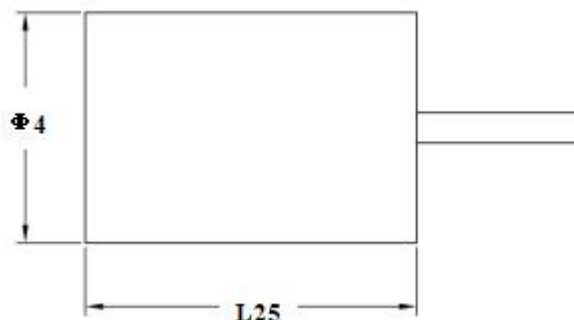

Ordering Information

GCHPPMECOLL-C-1-2-3-4-5-6

| | Lens Type | C-CLens ;G-GLen |
|---|-----------------------------------|---|
| 1 | Operating Wavelength | 1310=1310nm, 1550=1550nm, C=1528~1565, L=1570~1605, etc |
| 2 | Handling Power | 10W 20W 50W 100W , etc |
| 3 | Fiber Type | PM980 or PM1550 , etc |
| 4 | Beam Diameter | 0.3 ± 0.1 , etc |
| 5 | Package | 4x25, etc. |
| 6 | Bare Fiber Length With Loose Tube | 01 - 1m 02 - 2m etc. |