

## Polarization Maintaining fiber Collimator

### Features:

Low insertion loss  
High Efficiency  
stability and reliability

### Application:

Wave Fiber Laser  
High-Power Laser Equipment  
Experimental tests and other areas

Parameter	Value	Unit	Note
Operating Wavelength	$1550 \pm 40$	nm	
Insertion Loss	$\leq 0.25$	dB	
Return Loss	$\geq 50$	dB	
Beam Diameter ( $1/e^2$ )	-	mm	
Ellipticity	-	%	
M <sup>2</sup> Degradation	-	%	
Divergence (Full Angle)	-	mrاد	
Fiber Type	SM15-PS-U25D	-	
Φ3mm Armored Cable Length	-	m	
Φ0.9mm Loose Tube Length	-	m	
Fiber Length	$< 1.0$	m	
Handling Power	$\leq 500$	mW	
Operating Temperature	$-5 \sim +70$	℃	
Storage Temperature	$-40 \sim +85$	℃	
Dimensions (Φ*L)	Φ1.7x6.0	mm	glass tube

\*Insertion loss of light through fiber cladding is not included in the Insertion loss specification.

### Mechanical Dimension

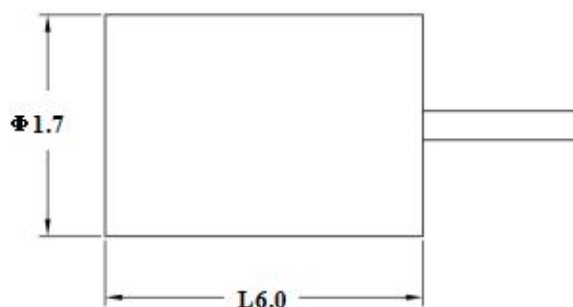

### Ordering Information

#### GCPMCOLL-C-1-2-3-4-5-6

	Lens Type	C-CLens ;G-GLen
1	Operating Wavelength	1310=1310nm, 1550=1550nm, C=1528~1565, L=1570~1605, etc
2	Handling Power	10W 20W 50W 100W , etc
3	Fiber Type	SM15-PS-U25D
4	Beam Diameter	$1. \pm 0.2\text{mm}$ ; $1.5 \pm 0.2\text{mm}$ , etc
5	Package	1.7x6.0, etc.
6	Bare Fiber Length With Loose Tube	01 - 1m 02 - 2m etc.