

980~1060nm High Power PM Circulator

Features

Low insertion loss
High extinction ratio
High stability & Reliability

Applications

Fiber Amplifier
Fiber sensor
Fiber Laser Marking
Laboratory R&D

Parameter	High Power	Low Power	Unit
	4 Port	4 Port	
Operating wavelength	980 、 1030、 1060 or customized		nm
Bandwidth	±5		nm
Typical peak isolation	≥30		dB
Isolation in band at 23°C	≥25		dB
Insertion loss at 23°C	≤1.8	≤1.5	dB
Extinction ratio	≥20 (SCF type) or ≥18 (DCF type)		dB
Return loss	≥45		dB
Fiber type (can be customized)	Panda PM fiber		-
Input max. power handling	10(CW)	0.3	W
Dimensions (L x W x H)	116 x 34 x 34		mm
Operating temperature	-5 ~ +50		°C
Storage temperature	-20 ~ +70		°C

*For 4 port type, the port 1 to 2, 2to 3, 3 to 4 and 4 to 1 is pass; the port 2 to 1, 3 to 2, 4 to 3 is isolated.

*The precondition of above specifications are extinction ratio of system ≥20dB.

*The above specifications are without connector, the connector handle power ≤0.3W.

*IL is 0.50dB higher, RL is 5dB lower and ER is 3dB lower for each connector added. The default connector key is aligned to slow axis.

Mechanical Dimension

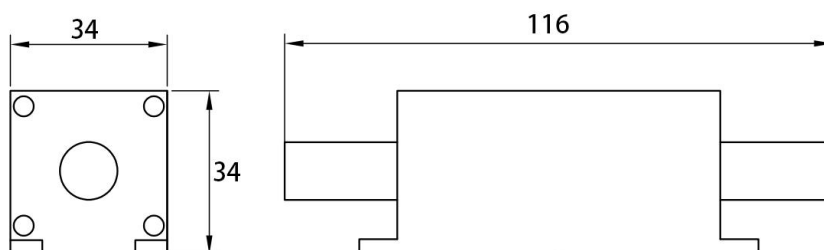

Ordering Information

specification	GCHPMCIR
Fiber length	Specify
Package size	116x34x34
Connector type	FC/UPC, FC/APC etc
Average power handling	300mW, 10W etc
Power condition	C=Continue Wave, P(10)=Pulse Peak Power(10KW),etc
Fiber type	specify
Pigtail diameter	0=bare fiber, 1=900μm, 2=2mm, 3=3mm
Operating wavelength	1030nm etc
Port type	4(4port)